



LEVEL INTELLIGENT LOCK INDUSTRIAL CO.,LTD

FOR YOUR SMART CHOICE



LEVEL® GUANGDONG LEVEL INTELLIGENT LOCK INDUSTRIAL CO.,LTD.

contact

TEL : +86-757-83998771 / 83998772 / 83998773

E-mail : info@levellock.com

QR Code

FAX : +86-757-83998770

WEB : www.levellock.com

Salels center: 3 Floor,67 bldg,Shidongxia Road, FoShan,China.

Production base: NO.I PingXi Industrial Park, PingZhou,NanHai,FoShan,China.



CONTENTS

01-02	32
Brief Introduction Of LEVEL Group	System Accessories
03	33-34
LEVEL Workshops	Virtual Online Lock System
04	35
LEVEL Certificate And Patent	Bathroom Lock
05-06	36
Selling Point Of LEVEL Hotel Lock System	Energy Saver
07-08	37-38
All-in-one Card Solution	Safe Box
09-10	39-53
Door Access Controller	Intelligent Lock For Residence And Office
11-12	54
Lift Access Control System	Handle Sheet
13-30	55-56
Hotel Intelligent Lock	Mortise
31	57-60
LEVEL Hotel Lock Management Software	Project Reference



Company

The history of Guangdong Level Intelligent Lock Industrial Co., Ltd. can be traced back to 1989 with an original name “Langtian Hardware Products Factory”, the professional manufacturer of hardware products. New name Guangdong Level Intelligent Lock Industrial Co., Ltd. was registered in 2003 as a high-tech enterprise engaged in development and application of microelectronics technology and hardware. As one of the largest intelligent lock manufacturers in mainland China, LEVEL is equipped with complete production lines and staffed with a team of high-level R&D engineers and managers, for which it firstly attained ISO9001: 2000 certificate in the same industry and also CE, RoHS, EN certificate etc. LEVEL perfect management and professional after-sale services system guaranteed high quality products and satisfying services to the clients

Strength

Level Group consists of six branches including Level Int'l (Asia) group, Guangdong Level Intelligent Lock Industrial Co., Ltd, Foshan Level Intelligent System Co., Ltd. Level Electronic Development Center, Level Mechanical Development Centre, and Level Software Development Center. Dedicated to the development, production and sales of intelligent locks and intelligent control system, LEVEL has been keeping exchanging of technology and cooperation in all respects with international partners who are specialized in lock system from Germany, Italy, Australia, USA, Turkey and Korea, by which we are the leader with international most advanced technology in lock industry in China. Thus an industrial pattern was formed as industry diversification, development Scalization, operation specialization, business regionalization and management Differentiation.

Creative

Look into the future, Level Lock will persist on a development strategy of top quality, excellent service and eminent brand. With the aim of enterprise value maximization and resources deploying globalization, Level will further perfect the firm organization and management pattern to make LEVEL the best Chinese brand in lock industry.



CREATIVE
With LEVEL

100%
EXCELLENT
Reliable quality

THOUGHTFUL
Continuous research and
development

LEVEL Workshops



PVD plating



Pressing workshop



Assembling workshop



Die-casting workshop



Plastic injection workshop



Tooling workshop



SMT production line



Mortise workshop



Sales center



Show Room



Meeting room

LEVEL Certificate



En14846



En12209



Certificate of interface with
MICROS-Fidelio PMS



GMC



TUV



SGS-ISO 9001-2000



RoHS



FCC



CE



Certificate of
supplier for 4 UN
organizations



Document of
supplier for 4 UN
organizations



Certificate of PC software
copyright registration

LEVEL Patents



PCB protector of
electronic lock



Time Device of
electronic lock



Clutch structure of lock



Handle-changing structure



Position-fixing structure
of handle



startup device of
fingerprint mainboard



Products design patent

Selling point of Level hotel lock system



Work with NFC mobile phone.

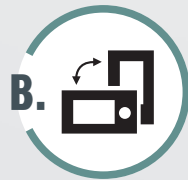

Could use upgrading cards to change hotel mode to office mode freely.



Could check opening records of some management cards, not only lock's records.



Equipped with mechanical key for double security.



With Public Door and Area Card function. One guest card could open maximal 7 rooms.



Stand-alone intelligent lock without cable connection, made up of intelligent card, intelligent lock and management software.



Translate the software to use your local language.



Software is workable in touch screen PC which runs Windows Operating System.



Breakfast ticket can be programmed into guest card.

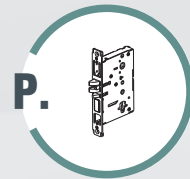

Using US or EU standard 5-latch mortise. Latches can be stainless steel according to customer's requirement, safe and reliable.



Single version or network version software for your choice, easy and convenient to install and use, could interface with very famous PMS, including Fidelio, Opera.



Wide application range: can be installed on wooden or metal door whose thickness >= 38 mm (US standard), 28 mm (EU standard).



Advanced backup system: special functional card to issue temporary guest card to avoid the inconvenience caused to customers and the chaos for management.



Low power waste, the static current can be ignored. The lock can be used for more than 1 year normally with 4pcs AA Alkaline (LR6) batteries.



One card solution, the same card for lock, car parking, elevator, building entrance, time attendance, consumption system, staff management system etc.



Alarm function: alarm works for improperly door closing, low battery voltage, or someone pastes the latches purposely.



Can be set as a Passage Lock (normal opening state), especially for conference.



Can store the latest 1000pcs unlocking records (including mechanical key and inside open).





Solution



Door Access Controller



Lift Access Control System



Hotel Intelligent Lock



Software



Energy Saver



Safe Box



Intelligent Lock For Residence And Office

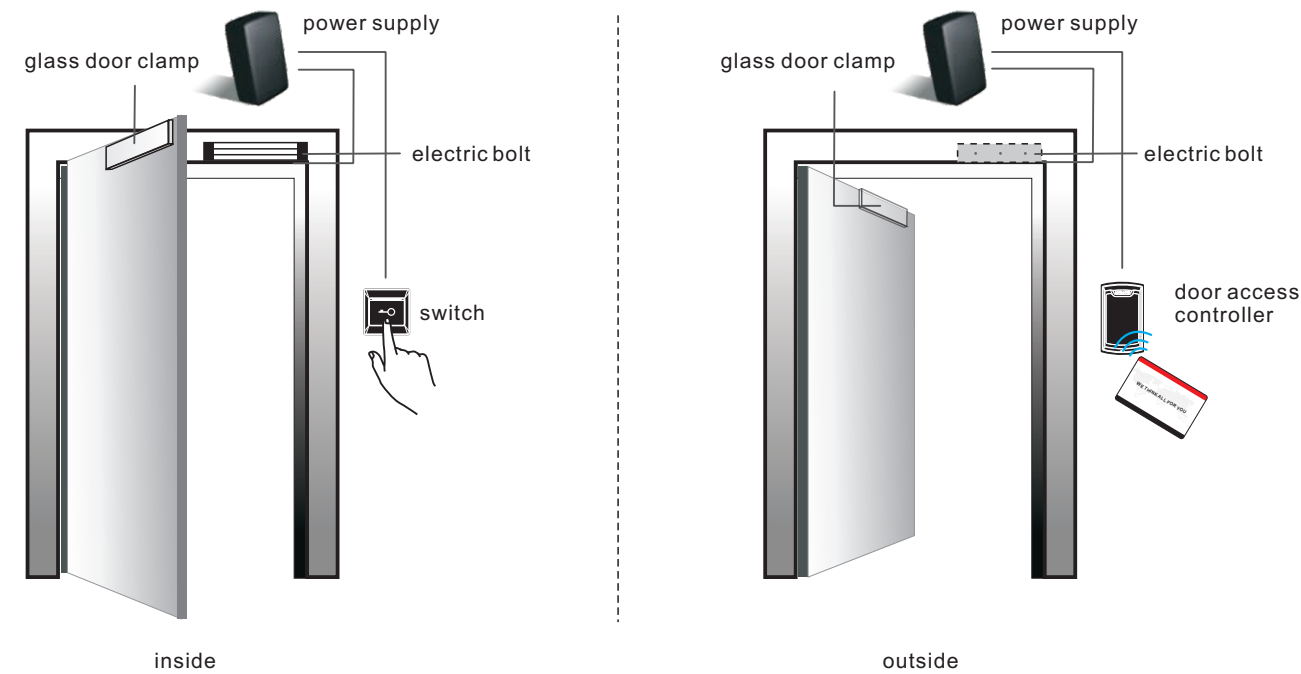

Function description

- * Release a door access by authorized valid MF1 card which could limit the access right of users and increase the security level.
- * Touch keypad reader for your choice. To protect user's privacy, a pretended code that contains the true one can be used for opening.
- * Support NFC mobile phone opening.
- * Door access, hotel lock and lift can be operated with one card, which is very convenient for users.
- * Normal open and Normal close can be set easily for special case.
- * Can set automatic opening during user-defined period, and one reader support multi locks.
- * The latest 1000pcs opening records can be tracked. When power fails, records can be saved well for at least 10 years.
- * With water-proof function (optional).
- * Relay release time: 0-35 seconds adjustable.
- * Connect with fire alarm device, could release the lock automatically upon signal.
- * Could connect with Open door switch and Video door phone for opening.

Parameters

Power	DC12~15V stable power supply
Store temperature / humidity	-20℃ ~ +80℃ / 10~95%RH
Working temperature / humidity	-10℃ ~ +70℃ / 15~90%RH
Reader working current	<150mA
Card type	Mifare one series IC card
Card reading distance	0-50mm
Reader dimensions	13.0cm×6.0cm×2.2cm
Opening record	The latest 1000pcs records
Maximal output	3A
Workable lock type	Rim lock, electromagnetic lock, electric strike

Composition of the product

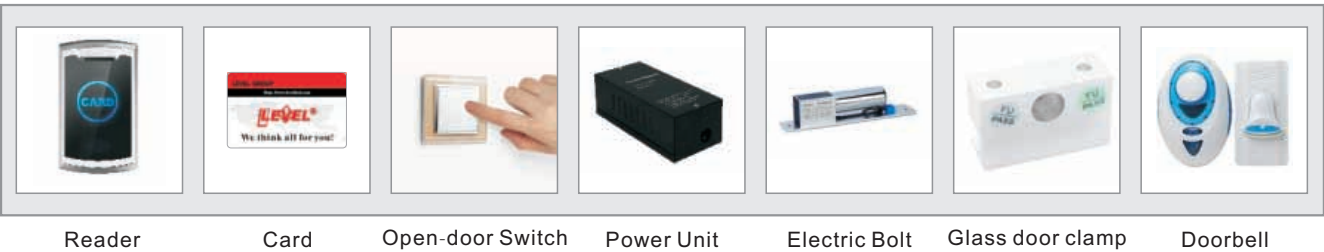

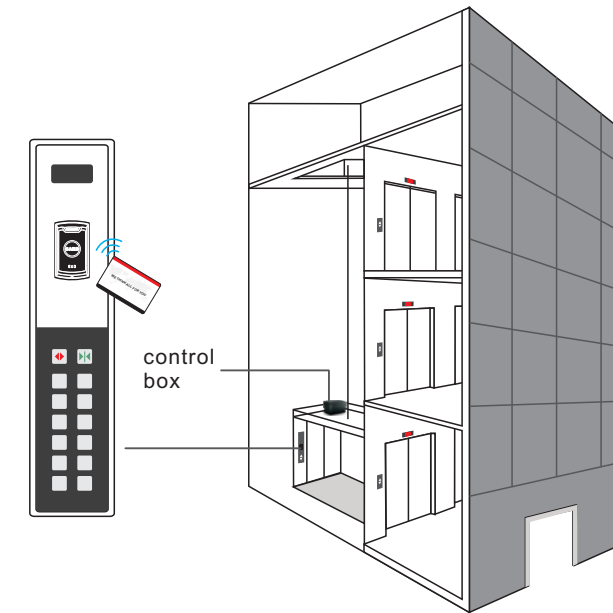

the lifts

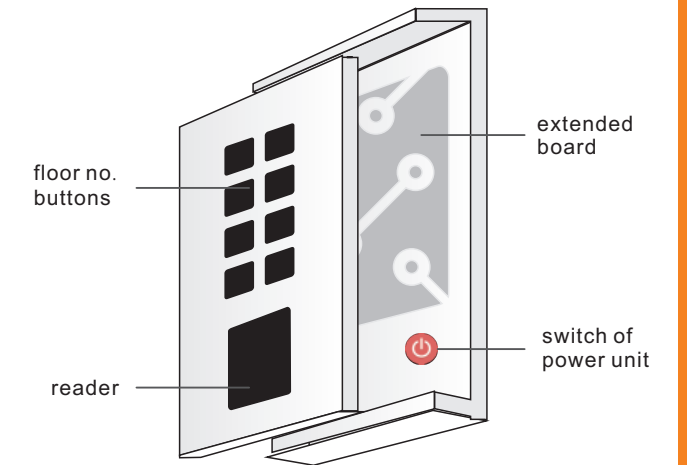

principle

Function description

- * Operating the lift by authorized valid MF1 card which could limit the access right of users and increase the security level.
- * Support NFC mobile phone opening.
- * Read the valid mono-floor card, the lift will go straight to the pre-setting floor without pressing the bottom. Read the valid multi-floor card, it needs to press the bottom after swiping card.
- * Lift, hotel lock and door access can be operated with one card, which is very convenient for users.
- * Multi-floor controlled: 16 floors can be controlled with one system main board and extended board, adding another extended board, 16 floors more can be controlled and maximal 4 extended boards are supported.
- * Connect by passive dry contact, LEVEL lift control system runs separately from the lift, Which is safe and reliable.
- * Card right of calling lift can be programmed for one single lift or several different lifts, one certain floor or different floors, and with valid period.
- * Each floor of the lift can be set as "controllable" or "incontrollable", and with valid period.
- * Blacklist management: 1000pcs cards can be put into the blacklist to avoid illegal use.
- * With self-protection function: connect with fire alarm device, when fire disaster happens, the system stops working till the fire alarm signal is cleared up. (The fire-fighting signal should be passive dry contact).

Parameters

Power	DC12~15V stable power supply
Store temperature / humidity	-20℃ ~ +80℃ / 10~95%RH
Working temperature / humidity	-10℃ ~ +70℃ / 15~90%RH
Reader working current	<150mA
Extended board working current	<300mA
Reader working current	<100mA
Card type	Mifare one series IC card
Card reading distance	0-50mm
Reader dimensions	13.0cm×6.0cm×2.2cm
Main board dimensions	16.3cm×10.1cm×2cm
Extended board dimensions	16.3cm×10.1cm×1.7cm
Lift calling record	The latest 1000pcs records
Application	Various lifts

Composition of the product



Reader

Card



Extended Board

Control Box

Always bring peace and comfort for guests, security and efficiency for hotel manager

With a history of 14 years in lock hardware production and 12 years in electronic lock manufacturing, Level has gained rich experience to develop high quality products which focus on securing hotel guests, their belongings and properties. The intelligent management software brings a high efficiency for hotel managers.

Reliable quality

Level carries out one set of strict rules on the respect of materials & process instrument choosing, examination of technicians, warranty of techniques and ensured the high quality.

Flexible and adapting solutions for hotel

Level provides flexible solutions with all requirements you ask for, and adapts our solutions to your specific needs.

Service

Service has always been an important part of our offering. Based on Level professional after-sales service system, we could provide any support and guidance on lock installation and maintenance, software running and upgrading etc.

Continuous research and development

Level looks for solutions continuously to meet the various requirements of market in all aspects such as PCB stability, power consumption, environment protection, Anti-static, anti-magnetic and weatherproof. Especially on the power consumption of RF lock, LEVEL is the pioneer to solve it thoroughly. With the humanized design, easy installation, simply operation, every user can enjoy LEVEL products without any setback from purchase to operation.

Hotel intelligent card lock, release you and your guests with a keycard!

Lock Parameters

- **Power Supply** :DC4.5 V-6.5V, 4pcs 1.5V LR6 alkaline batteries;
- **Store Temperature** :-20~+80℃;
- **Store Humidity** :10~90% RH;
- **Working Frequency** :13.56MHz;
- **Working Temperature** :-10~+60℃;
- **Working Humidity** :15~90% RH;
- **Card reading distance** :0-35mm;
- **Static Current** :< 15μA;
- **Dynamic Current** :<200mA;
- **Weight** :about 3.6 kg;
- **Unlocking Time** :
Turning the handle to open the door after reading the card,if doesn't turn handle within 3 seconds,the door will be locked again automatically.
- **Low Voltage Warning** :
When working voltage is less than 4.8V, indicator will be in red and buzzer sounds while unlocking. The lock can still be opened about 100 times before batteries are replaced.

LIS2008-RF-1380



● Characteristics

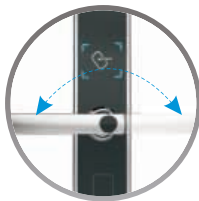

Interchangeable handle, L and R compatible.



No screws exposed, more elegant outlook.



With tamperproof alarm function when remove the panel.



With external power supply connector for 9V battery.

- Material: Plexiglass + Zinc Alloy
- Optional finishing: CFG, CR, SPVD
- Workable mortise: M001,M002,SSM003

● Specification

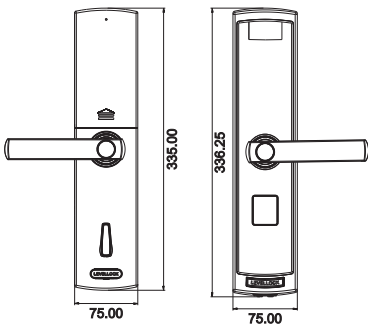

standard mortise:M001
suitable for ≥ 38 mm thickness doors

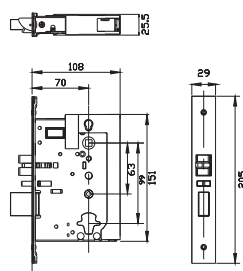

optional mortise:SSM003
suitable for ≥ 28 mm thickness doors

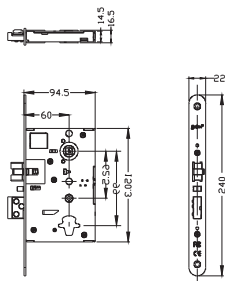

● Optional finishing



CR



SPVD



CFG

LIS2008-RF-1330



Sensitive induction



Korea style design,
elegant and bright.

● Characteristics

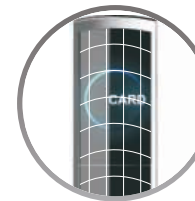

Korea style design,
elegant and bright.

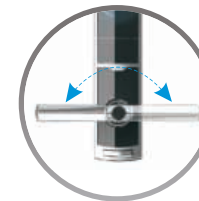

Interchangeable handle,
L and R compatible.



No screws exposed,
more elegant outlook.



Hidden cylinder,
more security.

- Material: Plexiglass + Zinc Alloy
- Optional finishing: RG, CR, SPVD
- Workable mortise: M001,M002,SSM003

● Specification

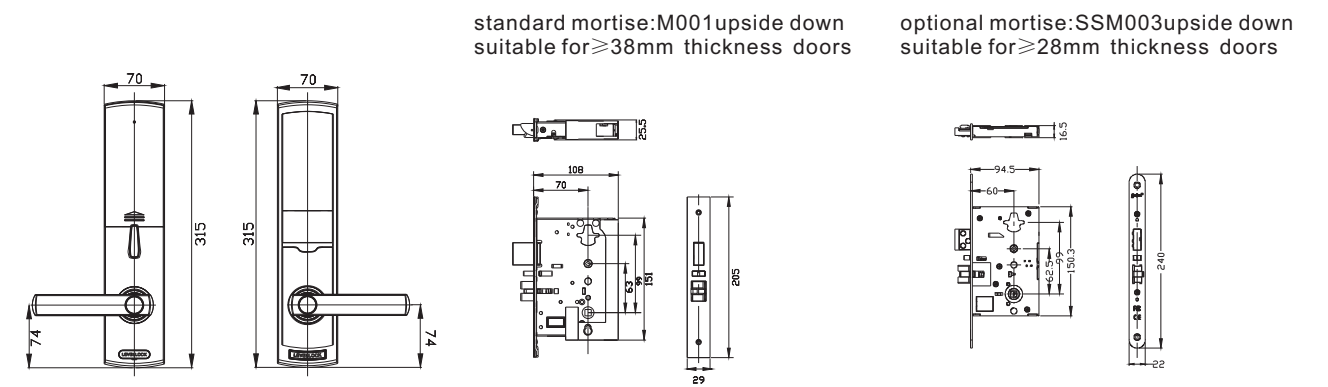

● Optional finishing



CR



SPVD



RG

LIS2008-RF-1690

Armored lock for outdoor use



Unique stylish reader

● Characteristics



Unique style reader,
3 pieces separately located.



Stainless steel material,
weather proof lock.



No screws exposed,
more elegant outlook.



Battery box in back panel,
easy for batteries replacement.

- Material: SUS 304
- Optional finishing: SS, PVD
- Workable mortise: EU type backset 45/50/55/60mm, center distance 72/85mm.

● Specification

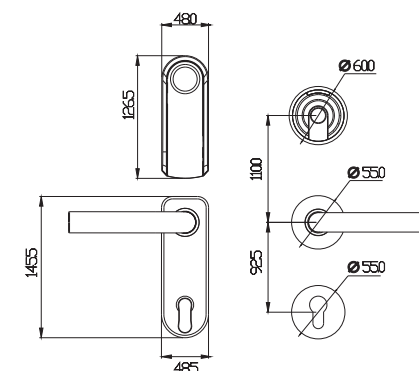

Standard mortise:
EU type backset 45/50/55/60mm
Center distance 72/85mm.

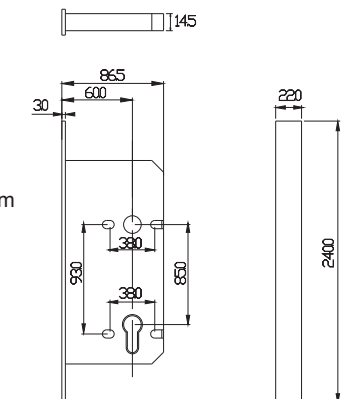

● Optional finishing



SS



PVD

LIS2008-RF-1660



Unique stylish reader

Characteristics



Unique stylish reader, 2 pieces separately located.



Hidden cylinder, more security.



No screws exposed, more elegant outlook.



Battery box in back panel, easy for batteries replacement.

- Material: Zinc alloy
- Optional finishing: DNCR, CR, CCR, PVD, SPVD
- Workable mortise: M001, M002, SS M003

Specification

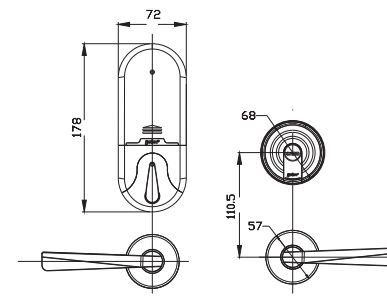

standard mortise: M001 upside down
suitable for ≥ 38 mm thickness doors

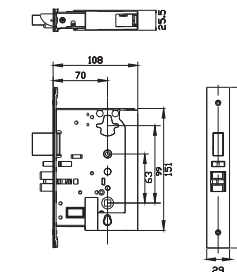

optional mortise: SSM003 upside down
suitable for ≥ 28 mm thickness doors

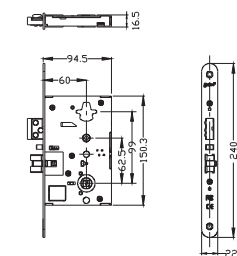

Optional finishing



CR



SPVD



DNCR

LIS2008-RF-1620



Special shape as shell

Characteristics



Special shape as shell,
2 pieces separately located.



No screws exposed,
more elegant outlook.



Hidden cylinder,
more security.



Battery box in back panel,
easy for batteries replacement.

- Material: Zinc Alloy
- Optional finishing: CR, CCR, PVD, SPVD
- Workable mortise: M001, M002, SSM003

Specification

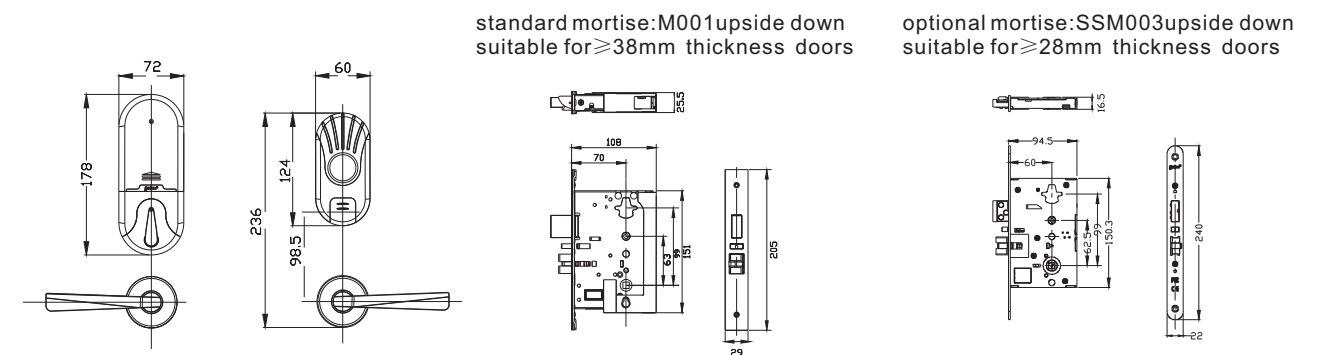

Optional finishing



CR



SPVD

LIS2008-RF-1550/20



Mirror process design

● Characteristics

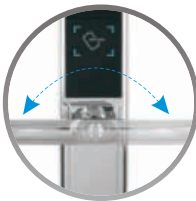

Interchangeable handle, L and R compatible.

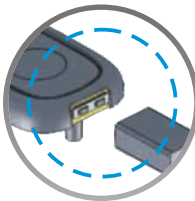

With external power supply connector for 9V battery.



No screws exposed, more elegant outlook.



Battery box in back panel, easy for batteries replacement.

- Material: Zinc Alloy
- Optional finishing: CR, SPVD
- Workable mortise: M001,M002,SSM003

● Specification

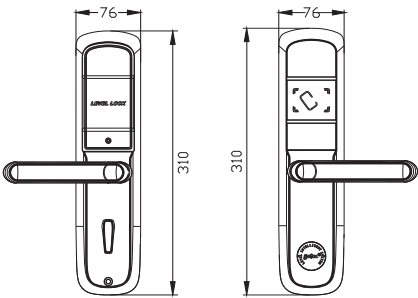

standard mortise:M001
suitable for≥38mm thickness doors

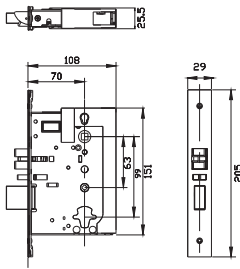

optional mortise:SSM003
suitable for≥28mm thickness doors

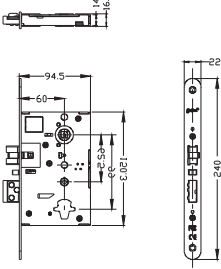

● Optional finishing



CR



SPVD

LIS2008-RF-S800LAS/32

Armored lock for outdoor use



SUS316 panels and handles,
anticorrosive and antirust

Characteristics

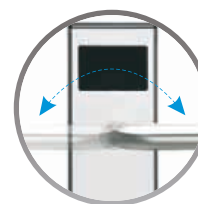

Interchangeable handle,
L and R compatible.



Sealed PCB, water and
high temperature proof



SUS316 panels and handles,
anticorrosive and antirust



Stainless steel mortise,
stronger and more reliable.

- Material: Stainless Steel
- Optional finishing: SS
- Workable mortise: SSM001, SSM002, SSM003

Specification

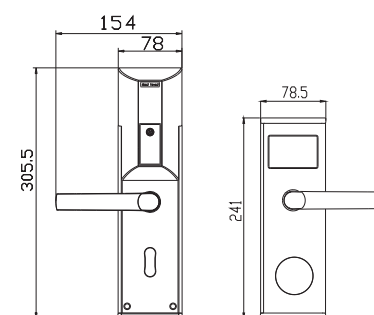

standard mortise:SSM001
suitable for ≥ 38 mm thickness doors

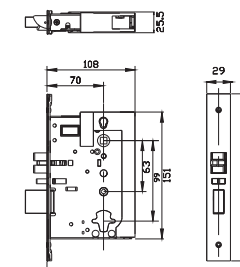

optional mortise:SSM003
suitable for ≥ 28 mm thickness doors

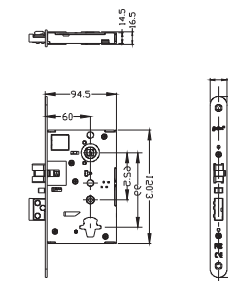

Optional handle



32# SS



33# SS

Hotel Lock Prodcut Sheet

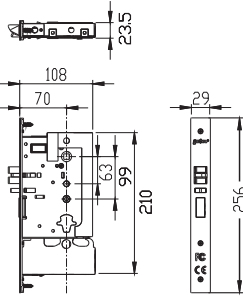

M001P (70mm mortise)
suitable for≥38mm thickness doors.

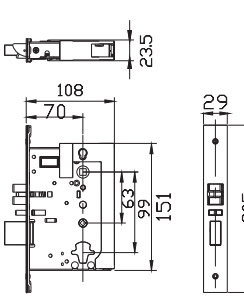

M001 (70mm mortise)
suitable for≥38mm thickness doors

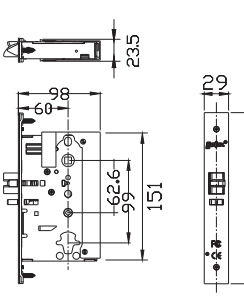

M002 (60mm mortise)
suitable for≥38mm thickness doors

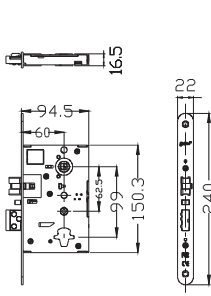

M003 (60mm mortise)
suitable for≥28mm thickness doors

LIS2008-RF-1300/20

Material:Zinc Alloy;
Finishing:CR/PCR, SPVD/PVD, SPVD/PCR;
Standard mortise:M001 upside down;
Optional mortise:SS M003 upside down.

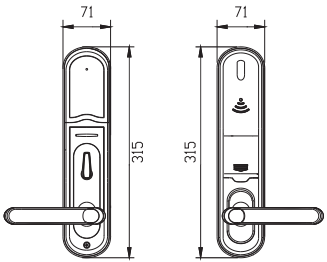

LIS2008-RF-1008/4

Material:Zinc Alloy;
Finishing:CCR,PVD;
Standard mortise:M001 ;
Optional mortise:SS M003 .

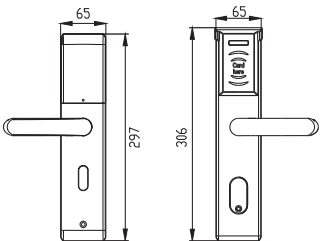

LIS2008-RF-1020iA/5

Material:Zinc Alloy+Stainless Steel;
Finishing:CCR,PVD;
Standard mortise:M001 ;
Optional mortise:SS M003 .

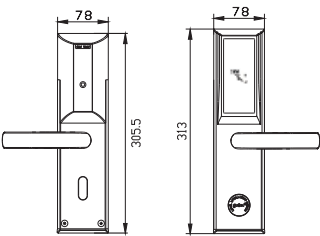

LIS2008-RF-1108AS/32

Material:SS;
Finishing:CCR,PVD;
Standard mortise:M001 ;
Optional mortise:SS M003 .

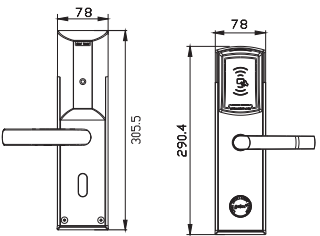

LIS2008-RF-S800AS/32

Material:SS;
Finishing:CCR,PVD;
Standard mortise:M001 ;
Optional mortise:SS M003 .

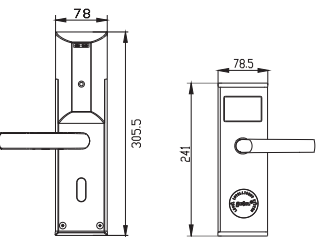

LIS2008-RF-N600/2

Material:Zinc Alloy
Finishing:CR/SCR,PVD/SCR,PVD/SPVD
Mortise:M001P

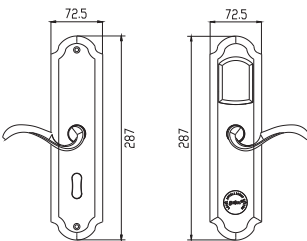

LIS2008-RF-N300/4

Material:Zinc Alloy
Finishing:CCR,PVD
Mortise:M001P

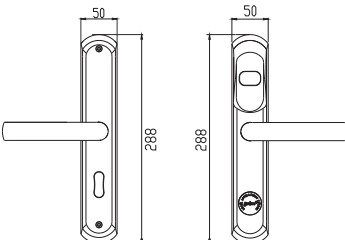

LIS2008-RF-N200/5

Material:Zinc Alloy
Finishing:CCR,PVD
Mortise:M001P

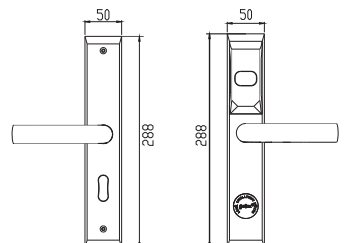

LIS2008-RF-N500/1

Material:Zinc Alloy;
Finishing:CCR,PVD;
Mortise:M002 upside down and
without deadbolt.

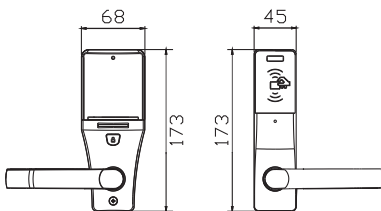

LEVEL Hotel Lock Management Software

★★ version

Introduction of LEVEL hotel lock management software

- * Could check opening records of some management cards, not only lock's records.(A)
- * Translate the software to use your local language.(B)
- * Software is workable in touch screen PC which runs Windows Operating System.(C)
- * Works in Windows XP / Vista / Win7 32/64 bit / Win8 OS.
- * Guest card for suite can be set to open main entrance door + any doors inside the suite (1-8 doors).
- * Automatic read/write card function to speedup check-in.
- * Speedily search and report function.
- * Guest card could be replaced by newly programmed one.
- * Single check-in and Group check-in function.
- * Special card including Floor card, Building card, Master card, Emergency card, Spare card, Check-out card ,Stop card, Data card etc.



wrtie opening records into card



translate local language



specaial card

★★★★★ version

Extension menu

- * Public door function.
- * Area card function.
- * One guest card could open maximal 7 rooms, host room and kith room.(D)
- * Special card could be replaced by newly programmed one.
- * Setting of User right, administrator could set different position and select each specified right for user.(E)
- * Interface with Fidelio/Opera.(F)
- * Search and report for consumption bill.
- * Guest information register.
- * Breakfast ticket can be programmed into Guest card.



check in



set user's right



interface

System accessories



* PNP Encoder

Made of ABS insulating material, Level PNP Encoder is used to read and write cards with characteristics of fast speed, plug and play. Works in Windows XP / Vista / Win7 32/64 bit / Win8 OS.



* 3 in 1 Hand terminal

One device with 3 functions of issuing Clock card, Installation card, and downloading unlocking records without a connection with computer, providing clients with most convenient and high efficiency solution.



* Dongle

A key to lock software, and double security for your mangement.



* Card

MF1 card, can be issued to different types of cards with different functions to open the lock, can be reported lost, recycled and reused.



* DAQ SET

Information card
It is used to retrieve all information of PCB, including detailed parameter settings of lock, card type code, blacklist of card ID, status of lock etc. which plays a very important role in some special situation. For example, certain rooms have things stolen.

Record card
It is used to retrieve unlocking records from PCB, including the one by mechanical key and inner handle.

Virtual Online Lock System

Spec:AC input AC220V 50Hz;DC output;DC12V 3A
Logic wiring diagram:

controller box

Schematic diagram

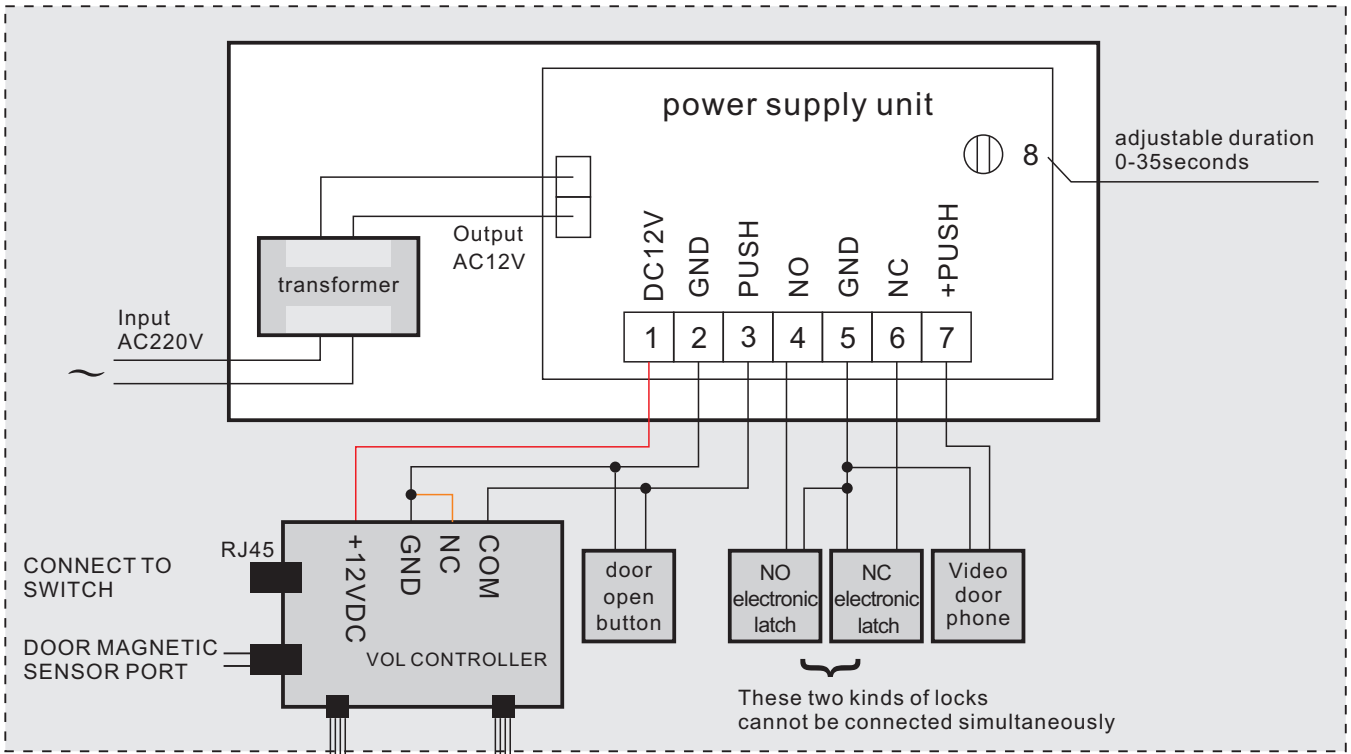
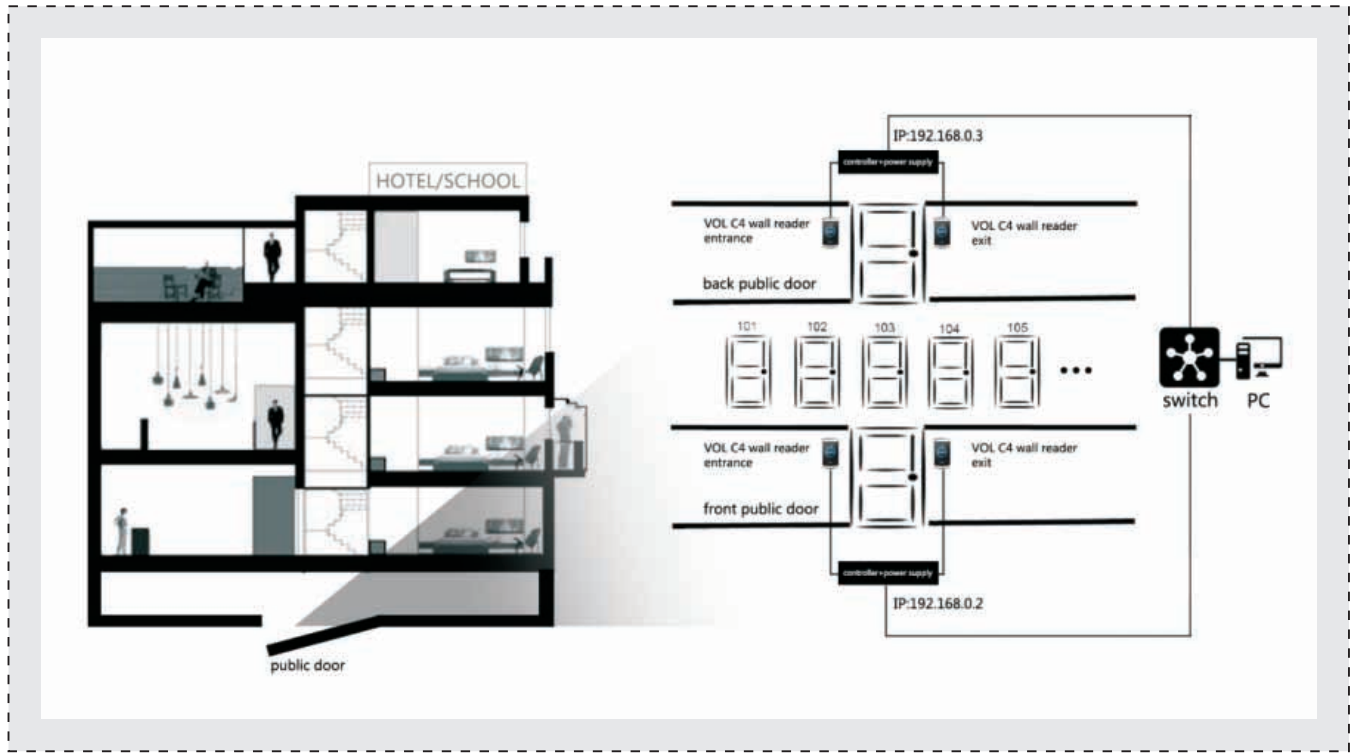

VOL major features

- 1.Real-time monitor on the public door wall reader
- 2.Entrance and Exit dual-traffic security:both entrance and exit require valid card
- 3.Support remote issuing card, remote report loss card
- 4.Support to read recent trail audit from guest card when it is presented to exit VOL wall reader
- 5.Remote update card access right by Entrance VOL wall reader
- 6.Support to read door lock battery status when the guest card is presented to Exit VOL wall reader
- 7.Prevent the suspect person from exit. If he tried to open wrong doors for over 3 times, this suspect person can neither open any door nor unlock the Exit VOL wall reader.

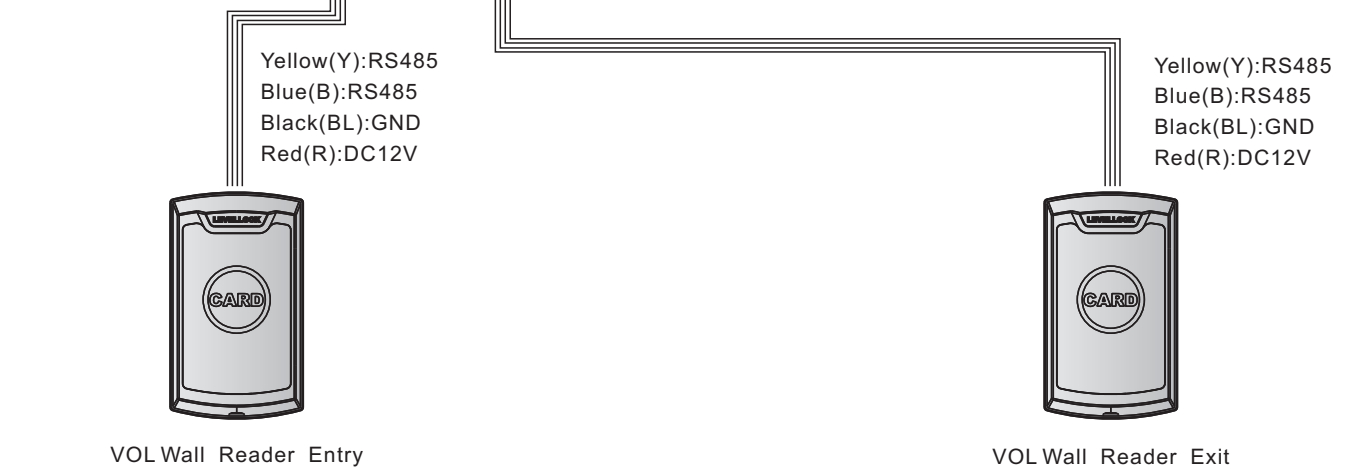



Bathroom Lock

The style matches with electronic lock, making sure decoration is consistent and harmonious.



W1-1202

Finishing:CR/SCR,SPVD/SCR,SPVD/PVD



W1-1101

Finishing:CCR,PVD

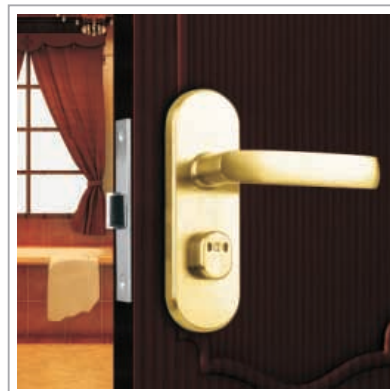

W1-1503

Finishing:CCR,PVD

Characteristics

- Made by high-precision alloy casting in optical finishing(CCR and PVD),pure and durable.Patented lock-from- inside structure,humanistic design,reliable and durable.
- Can turn the handle to open the door one step(patent) from inside,and no need turn dead bolt.
- With red and green indicator to display lock status.

Energy Saver



SW-2000N

Normal Energy Saver,works with any type of card



SW-2000M1

RF Energy Saver,works with Philips MF1 card.

SW-6000RMF1

RF Energy Saver,works with Philips MF1 card with correct room number.

SW-2000N / SW-2000M1

Working voltage : AC 50/60Hz 100-120V,
50Hz 200-240V,60Hz 200-240V

Load current : 30A

Self-consumption power waste : <3W

Lifetime of contact of relay : > 100,000 times at 220V 20A

Delay-time after power off : 8-15s

Working temperature : -10℃~60℃

Working humidity : 10~95%RH

Environment : -20℃~80℃ for transportation and stock

Installation : Level standard 86 base box

Exterior dimension : W86 X H86 X D42mm

SW-6000RMF1

Working voltageAC : 50/60Hz 100~250V

Load current : <30A (suggest 16A)

Self-consumption power waste : <3W

Lifetime of contact of relay : > 100,000 times at 220V 20A

Delay-time after power off : 8-15s

Working temperature : -10℃~60℃

Working humidity : 10~95%RH

Environment : -20℃~80℃ for transportation and stock

Installation : Level standard 86 base box

Exterior dimension : W86 X H86 X D42mm



Model: SF-800B-DG/MF

- 1. Size: H200xW420xD370;
- 2. Color: Ivory \Black ;
- 3. Thickness: 1.2mm(body), 5mm(door);
- 4.Three ways to open and close:
 - a. different types of cards based on software setting;
 - b. code;
 - c. mechanical key.

- 1. Compatible with LEVEL MF1 card hotel lock system in the same software. When program Cards, tick “open safe”, the same card can open both safe box and hotel lock.
- 2. Use Installation Card to set working mode, card only or card + code.
- 3. One User Code with 3-8 digits.
- 4. Use Stop Card to terminate functions of card and code, in this case only Master card and Emergency card can open it.
- 5. The latest 1000pcs unlocking records can be downloaded by Hand Terminal.
- 6. International standard ADA digit keyboard and the advancing one time molding technology are adopted in manufacturing the box.
- 7. Supporting LED and multiple operational messages displaying, such as error tips and programming status.
- 8. Wrong codes input 3 times continuously, it will be self-locked for 5 minutes, safer and reliable.
- 9. With low voltage alarm function and error beeps.
- 10. Low power consumption: 4pcs 1.5V AA alkaline battery can be used normally for more than one year.



Model: SF-830B-DG

- 1. Size: H180xW400xD350;
- 2. Color: Ivory \Black ;
- 3. Thickness: 1.5mm(body), 5mm(door);
- 4. Two ways to open and close:
 - a. code;
 - b. mechanical key.

- 1.International standard ADA digit keyboard and the advancing one time molding technology are adopted in manufacturing the box.
- 2.3-6 digit codes are for option.
- 3.Supporting LED displaying and multiple operational massage, such as battery status, error tips, programming status and door opened record.
- 4.With many accessories for option, such as emergency mechanical keys, emergency decoder, computer connector and software for printing statements.
- 5.Two sets of code are provided: user code for guests and master code for management (optional).
- 6.Emergency decoder is equipped for higher management.
- 7.Wrong codes input four times continuously, self-lock function of the system will be acted, safer and reliable.
- 8.Multiple working modes are for option: personal mode and hotel mode.
- 9.The latest 100 times opening record can be printed.
- 10.Low power consumption: 4pcs 1.5V AA alkaline battery can be used normally for more than one year.

parameter

Working voltage:	4.5-6.5V
Working temperature	0℃ ~ +45℃
Static current:	<15uA
Dynamic current:	<200mA

Level intelligent lock for
“residence and office”

With LEVEL,we enjoy the life of technology,and start our dreams from fingertips

Lock parameters | Keypad/card lock

- **Power supply:** DC 4.5~6.5V ;
- 4pieces of 1.5V AA alkaline batteries ;
- **Static current:** 15μA ;
- **Dynamic Current:** <200 mA;
- **Password:** 100pcs MF1 card + 2 groups password
- **Store temperature:** -20~+85℃;
- **Store Humidity:** 10~85% RH;
- **Working temperature:** -8~+60℃;
- **Working Humidity:** 15~85% RH;
- **Working frequency:** 13.56MHz (MF 1)
- **Reaction time:** ≤100ms
- **Low Voltage Warming:**
Another100 times opening since the first low-power warming given out by the lock.
Applied to wooden or metal door of 28~75mm door thickness.

Lock parameters | Fingerprint / Keyad lock

- **Fingerprint collected time:** <0.5 second;
- **Static power waste:** ≤20 μ A.
- **Fingerprint contrast time:**<1second;
- **FRR:**≤1%
- **FAR:**≤0.0001%
- **Operating temperature:** -8℃—+60℃;
- **Working voltage:** 4.8-6.0V, 4pcs of1.5V AA alkaline batteries;
- **Capacity:** 100pcs fingerprints + 2 groups password
- **Fingerprint setting template:** twice form a template;
- **Fingerprint window solution:** 500pdi;
- **Dynamic power waste:** <200mA;

Lock parameters | RF card lock

- **Power supply:** DC 4.5~6.5V ;
- 4 pieces of 1.5V AA alkaline batteries ;
- **Static current:** < 15μA ;
- **Dynamic Current:** <200 mA;
- **Store temperature:** -20~+85℃ ;
- **Store Humidity:** 10~85% RH;
- **Working temperature:**-8~+60℃ ;
- **Working Humidity:** 15~85% RH;
- **Working frequency:** 13.56MHz (MF 1);
- **Reaction time:** ≤100ms.



LI 2010- TDT-1380
Card & Password

LI 2010-MT-1380
Fingerprint & Password

● Characteristics



LED screen, English menu for easy operations

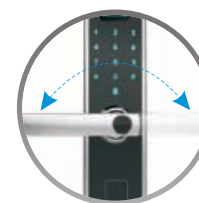

Interchangeable handle, L and R compatible

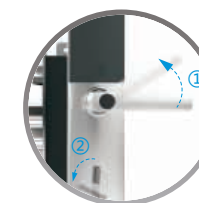

Two ways for security deadbolt locking, turn inside knob or lift outside handle



With tamperproof alarm function when remove the panel



With doorbell function



Maximal 30 digits can be input for protecting the correct code unexposed



With external power supply connector for 9V battery

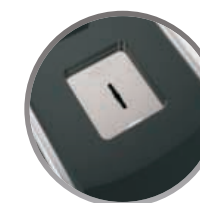

Hidden cylinder, more security

- Material: Plexiglass + Zinc Alloy
- Optional finishing: CFG, CR, SPVD
- Workable mortise: Stainless steel 6068 mortise with or without heaven and earth bolt for your choice

● Specification

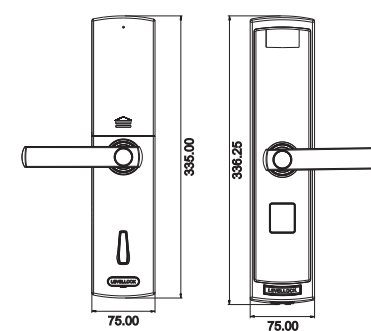

Standard mortise:
SS 6068 mortise

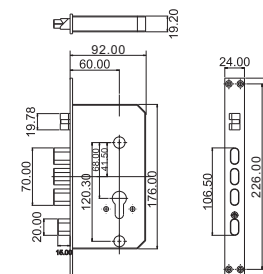

Optional mortise:
SS 6068 mortise with heaven and earth bolt

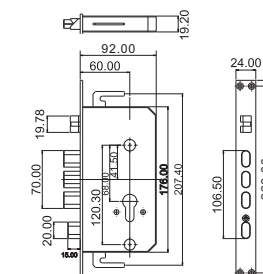

● Optional finishing



CR



SPVD



CFG

LI 2010-MT-1300

Fingerprint & Password

LI 2010-DT-1300

Card & Password

Characteristics



Sensitive Touch detection



Interchangeable handle, L and R compatible



Hidden cylinder, more security



Push-up metal battery case cover



Maximal 30 digits can be input for protecting the correct code unexposed

- Material: Zinc Alloy
- Finish :PVD/PCR , PVD/SPVD , CR/PCR
- Workable mortise : SS M001, SS M002, SS M003

Specification

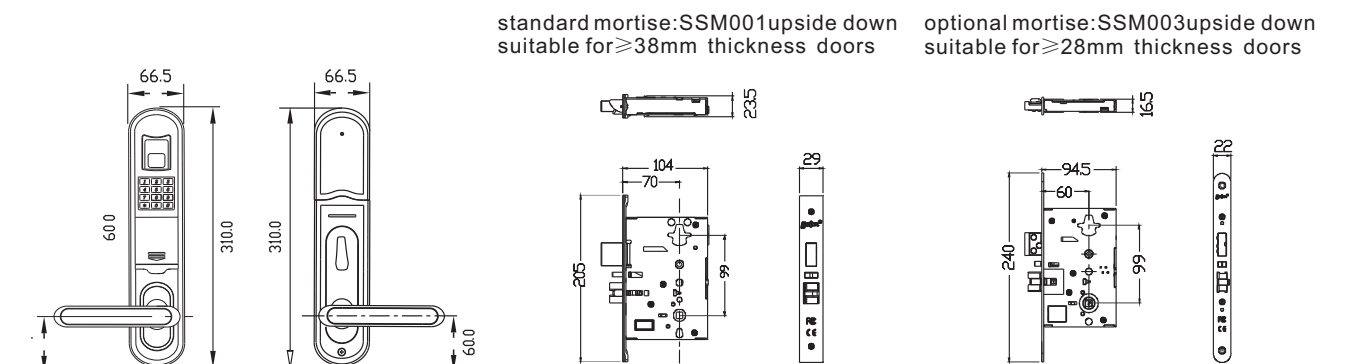

Optional finishing



CR/PCR



PVD/PCR



PVD/SPVD

LI 2010-TDT-1020

LI 2010-DT-1020

LI 2010-MT-1020



● Characteristics



Interchangeable handle,
L and R compatible



With external power
supply connector for 9V
battery



SUS304 panels



Battery box in back panel, easy
for batteries replacement

- Material: Zinc Alloy+stainless steel
- Optional finishing: CCR, PVD
- Workable mortise: SS M001, SS M002, SS M003

● Specification

standard mortise:SSM001
suitable for $\geq 38\text{mm}$ thickness doors

optional mortise:SSM003
suitable for $\geq 28\text{mm}$ thickness doors

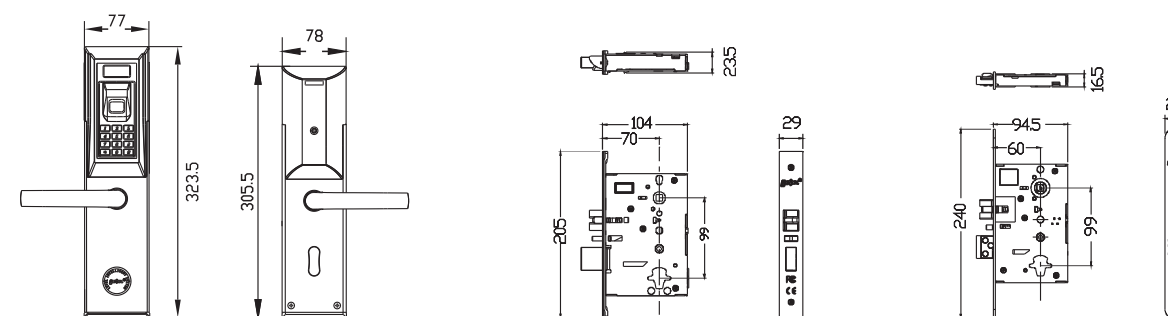

● Optional finishing



CCR



PVD

LI 2010-MT-1800



Characteristics



Interchangeable handle,
L and R compatible



Sensitive Touch detection



Hidden cylinder,
more security



With external power
supply connector for 9V
battery

- Material: Zinc Alloy
- Optional finishing: CCR, PVD
- Workable mortise: 60/70 single-latch

Specification

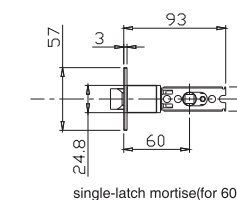
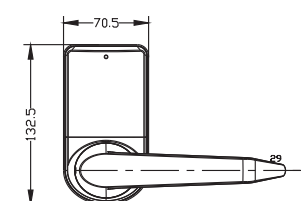
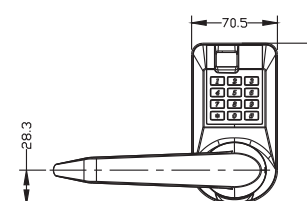

single-latch mortise(for 60)

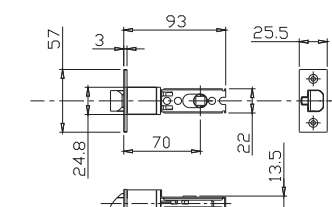

single-latch mortise(for 70)

Optional finishing



CCR



PVD

LI 2010-TDT-1330



TDT-1330

● Characteristics

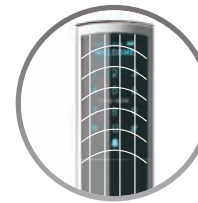

Korea style design,
elegant and bright

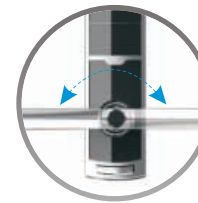

Interchangeable handle,
L and R compatible



No screws exposed,
more elegant outlook



Hidden cylinder,
more security



With doorbell function



LED screen, English menu
for easy operations



Maximal 30 digits can
be input for protecting
the correct code
unexposed



With external power
supply connector for 9V
battery

- Material: Plexiglass + Zinc Alloy
- Optional finishing: RG, CR, SPVD
- Workable mortise: SSM001, SSM002, SSM003

● Specification

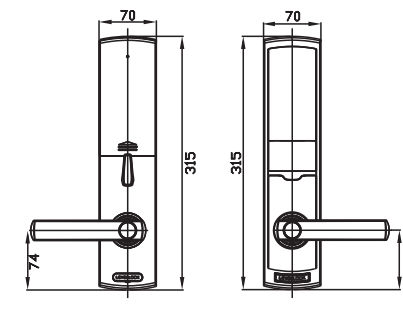

standard mortise:SSM001upside down
suitable for ≥ 38 mm thickness doors

optional mortise:SSM003upside down
suitable for ≥ 28 mm thickness doors

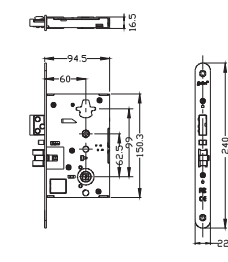
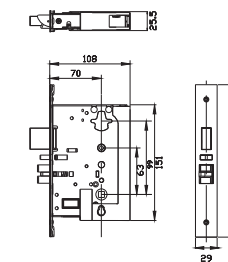

● Optional finishing



CR



SPVD



RG

LI 2010-TDT-1550



Characteristics

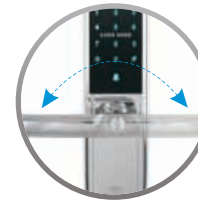

Interchangeable handle,
L and R compatible

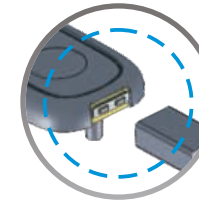

With external power supply
connector for 9V battery



No screws exposed,
more elegant outlook



Battery box in back panel,
easy for batteries replacement



With doorbell function



LED screen, English menu
for easy operations



Maximal 30 digits can
be input for protecting
the correct code
unexposed



Hidden cylinder, more
security

- Material: Plexiglass + Zinc Alloy
- Optional finishing: CR, SPVD
- Workable mortise: SS M001, SS M002, SS M003

Specification

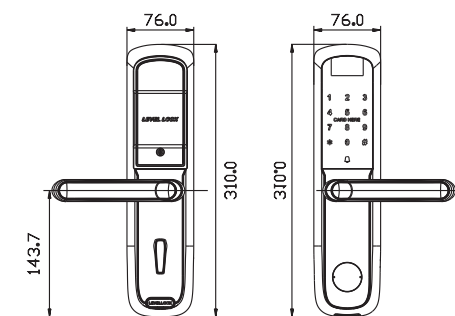

standard mortise:SSM001
suitable for ≥ 38 mm thickness doors

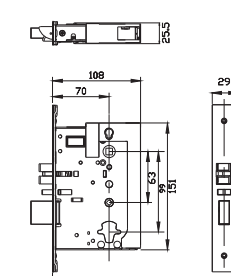

optional mortise:SSM003
suitable for ≥ 28 mm thickness doors

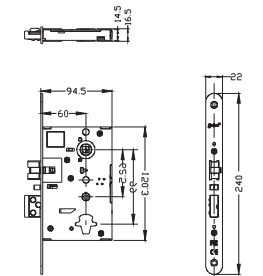

Optional finishing



CR



SPVD

LEVEL RF card lock for residence and office



LIS2018-RF-1330
Finish:RG, CR, SPVD
Mortise:SSM001 upside down



LIS2018-RF-1690
Finishing:SS,PVD
mortise:EU type backset 45/50/55/60mm,
center distance 72/85mm.



LIS2018-RF-1660
Finish:NCR, CCR, CR, PVD, SPVD
Mortise:M001 upside down



LIS2018-RF-1620
Finish:CCR, CR, PVD, SPVD
Mortise:M001 upside down



LIS2018-RF-1380
Finishing:CFG, CR, SPVD
mortise:SS6068



LIS2018-RF-1550
Finish:RG, CR, SPVD
Mortise:SSM001



LIS2018-RF-1300
Finish:CR/PCR, PVD/SPVD, PVD/PCR
Mortise:SSM001 upside down



LIS2018-RF-1008
Finish:CCR,PCR,PVD,AC,AB
Mortise:M001



LIS2018-RF-1020i
Finish:CCR, PVD
Mortise:M001



LIS2018-RF-1108AS
Finish:CCR, PVD
Mortise:M001



LIS2018-RF-S800
Finish:CCR, PVD
Mortise:M001



LIS2018-RF-S800L
Finish:CCR, PVD
Mortise:M001



LIS2018-RF-N200
Finish:CCR, PVD
Mortise:M001P



LIS2018-RF-N300
Finish:CCR, PVD
Mortise:M001P



LIS2008-RF-N600/2
Finish:CR/SCR,PVD/SCR,PVD/SPVD
Mortise:M001P



LIS2018-RF-N500
Finish:CCR, PVD
Mortise:M002 upside down and
without deadbolt

Handle Sheet

zinc alloy handles:



1# handle



2# handle



4# handle



5# handle



7# handle



10# handle



14# handle



15# handle



17# handle



20# handle



22# handle



25# handle



29# handle



30# handle



31# handle

stainless steel handles:



18# handle



32# handle



33# handle



Rust prevention, durable
1 million test, inspection zero fault



● Specification

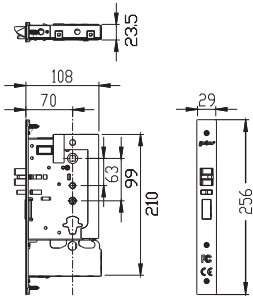

M001P (70mm mortise)
standard:zinc alloy latches
optional:stainless steel latches

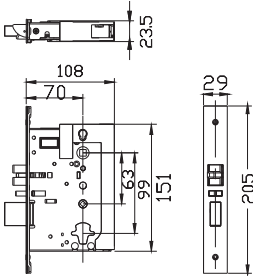

M001(70mm mortise)
standard:zinc alloy latches
optional:stainless steel latches

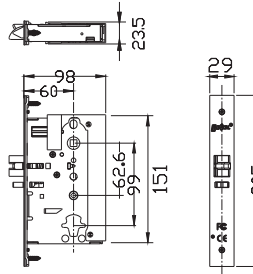

M002 (60mm mortise)
standard:zinc alloy latches
optional:stainless steel latches

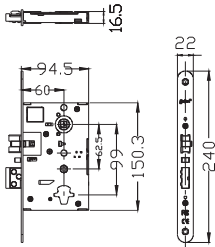

M003 (60mm mortise)
standard:stainless steel latches

● Characteristics

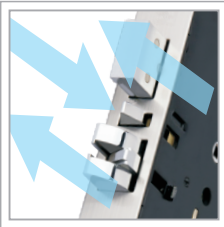

Up to 1,000,000 times life cycle test:
The latches and deadbolt mechanism functions correctly after 1,000,000 times cycle test, which is far in the lead of the same product in the country.

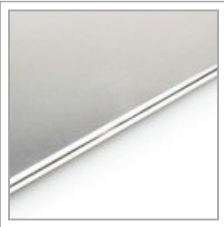

Casting stainless steel material:
Inside complex latch, safety latch and main moving parts are made of Ss304.
Deadbolt latch is combined by alloy steel and imported cold-rolled steel with high strength rivet.



Special surface treatment:
Adopting Japanese electrophoresis coating, which is rustproof and durable.



Automatic detect function:
Lock can give alarm voice and flash when safety latch detects unusual closed condition, it will be double safe and more secure.

Project Reference

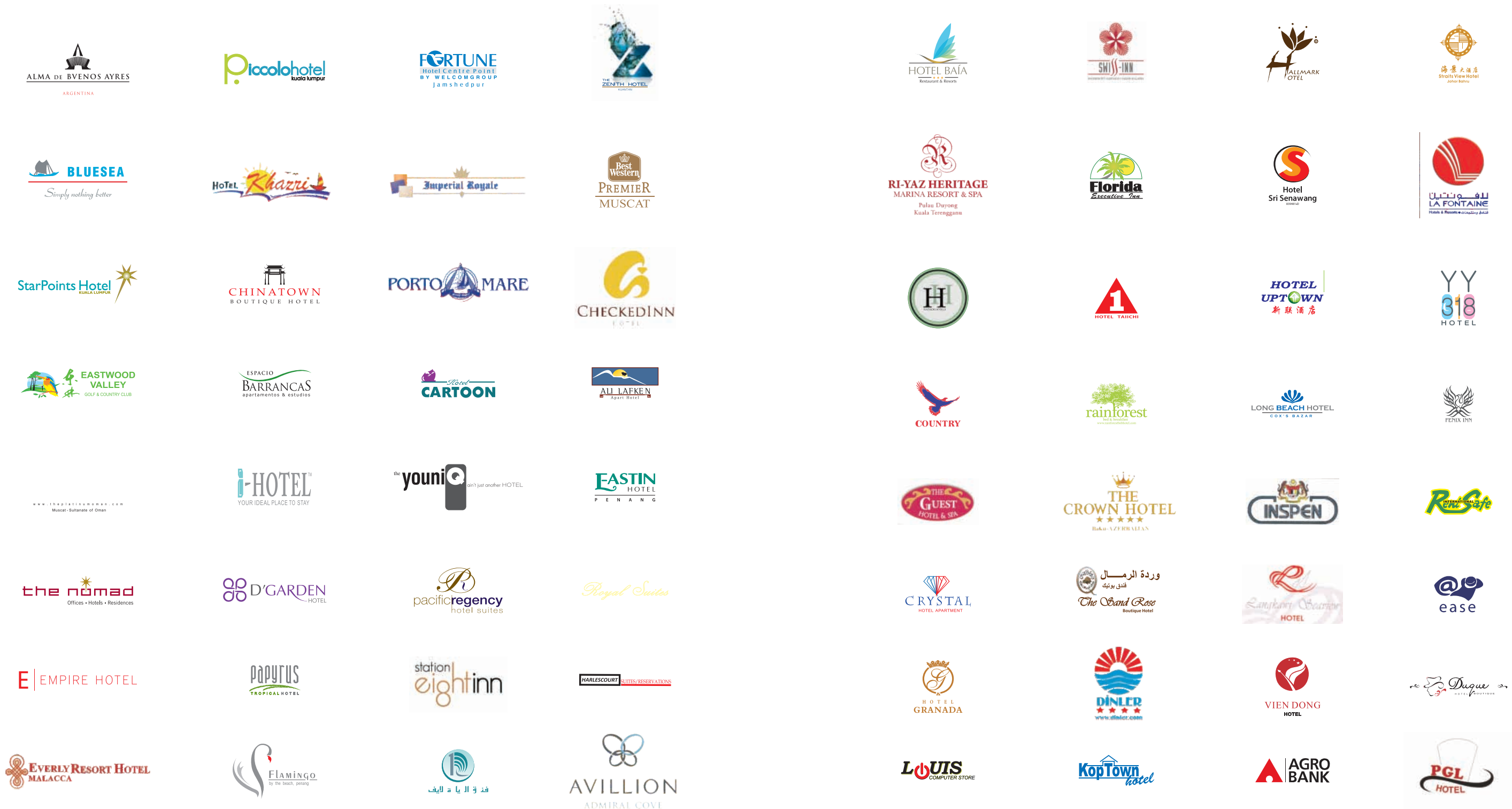

^2015



LEVEL LOCK
Have been all over the world

Project Reference

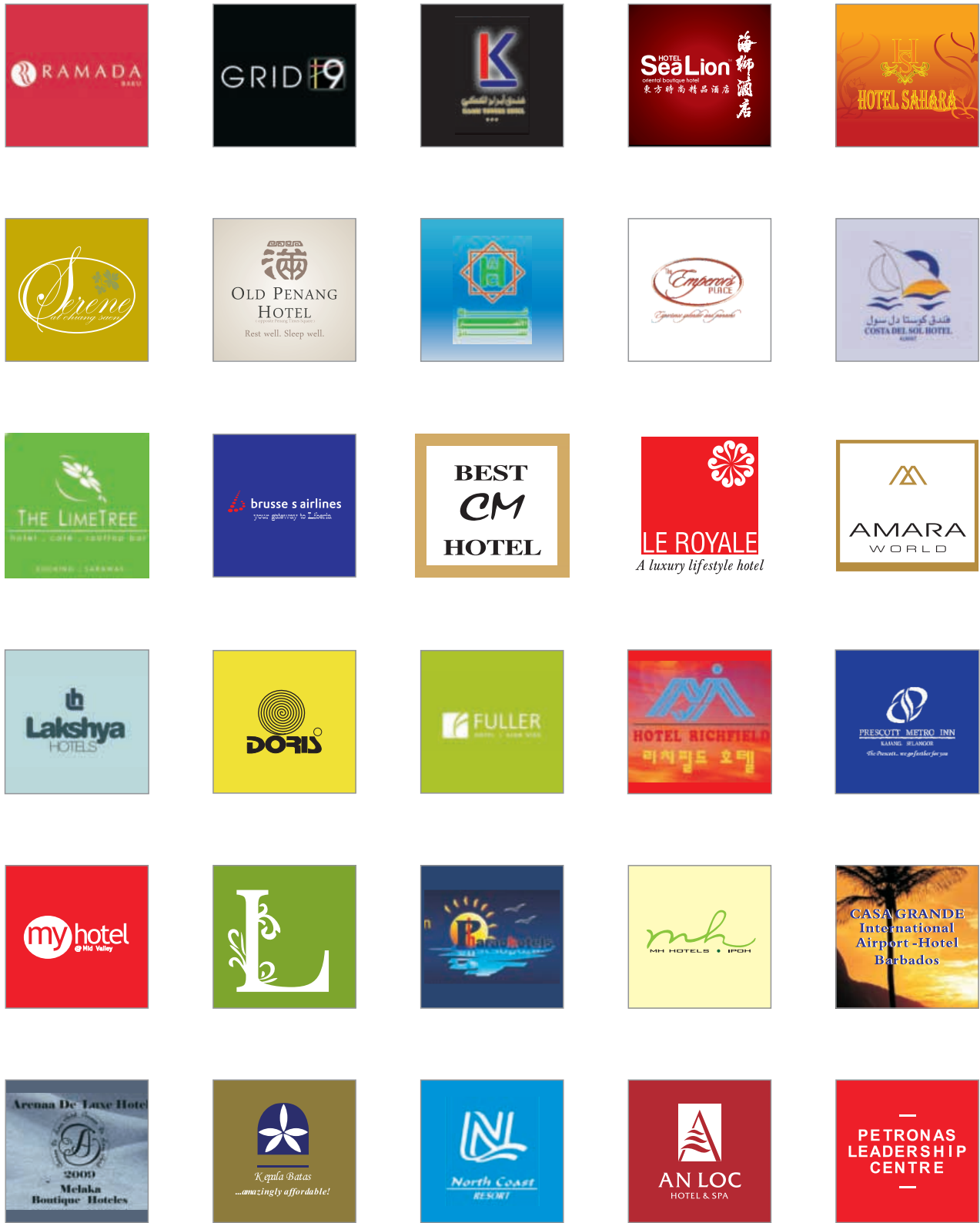

Some Domestic Five-star Project Cases

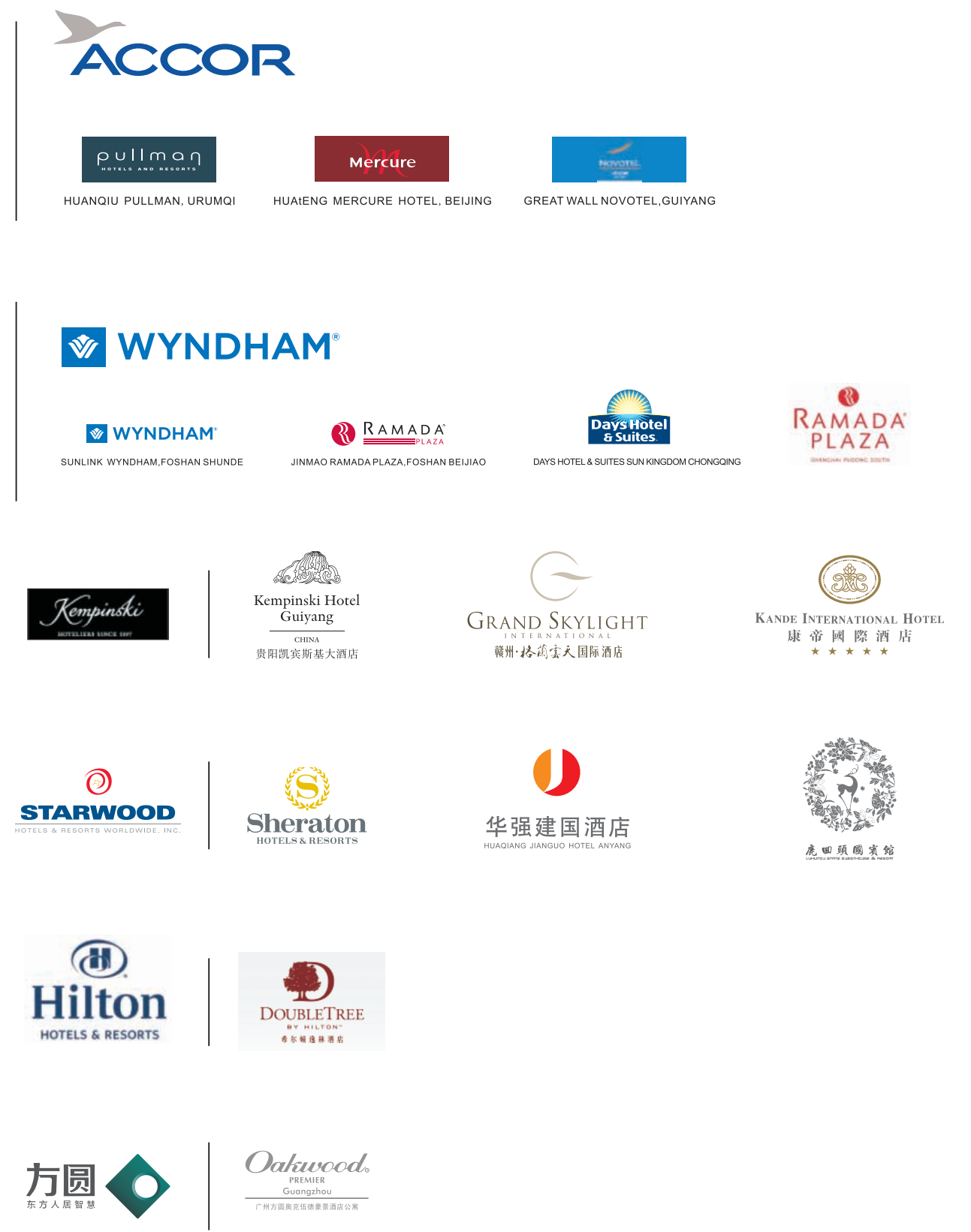

^2015



LEVEL LOCK
Have been all over the world